



TT - 3450S



TT - 4550S

**OPERATING INSTRUCTIONS
& SPARE PARTS**
(Mains operated machines)



Original Instructions
Warning! read instructions before
using machine.

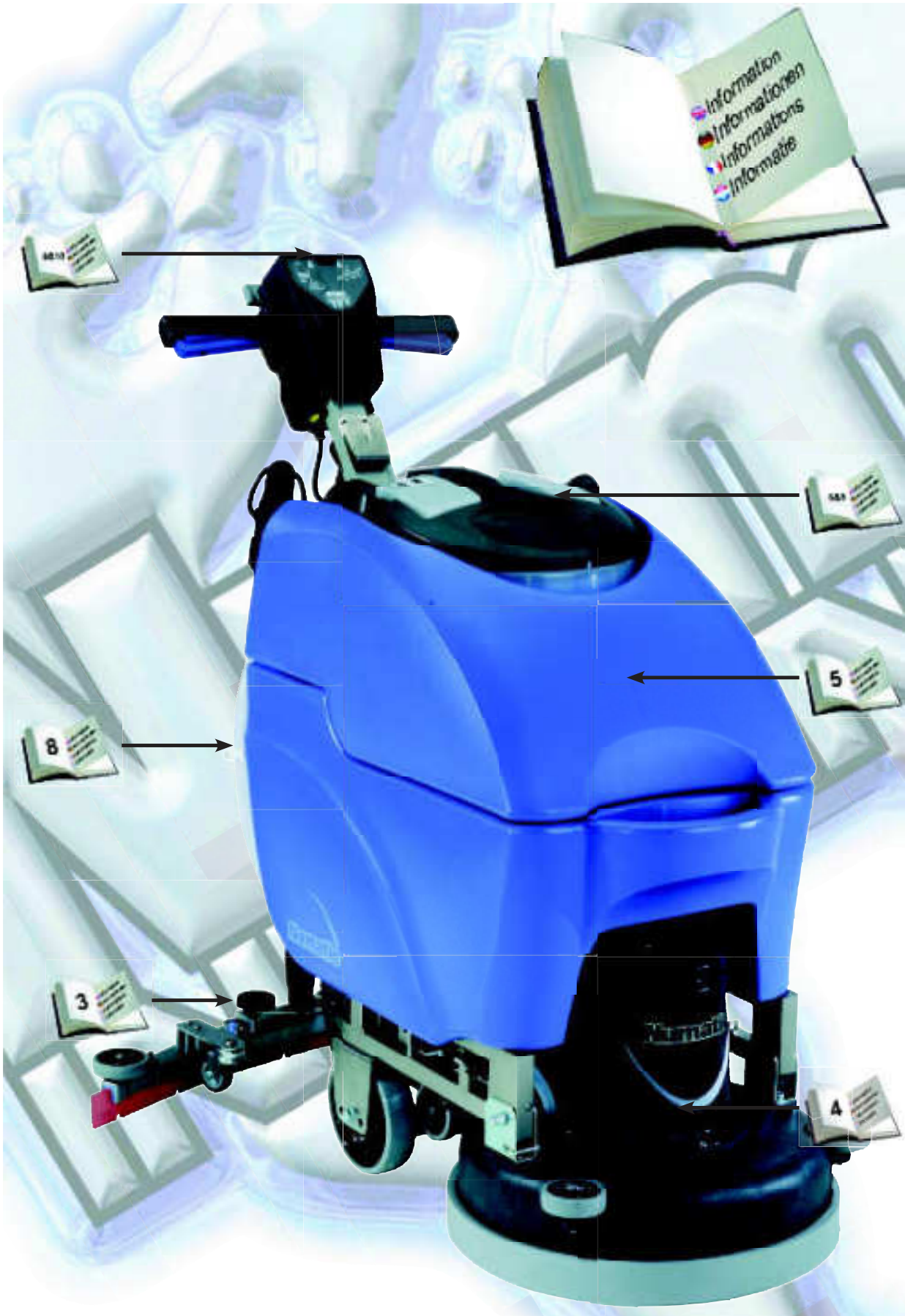

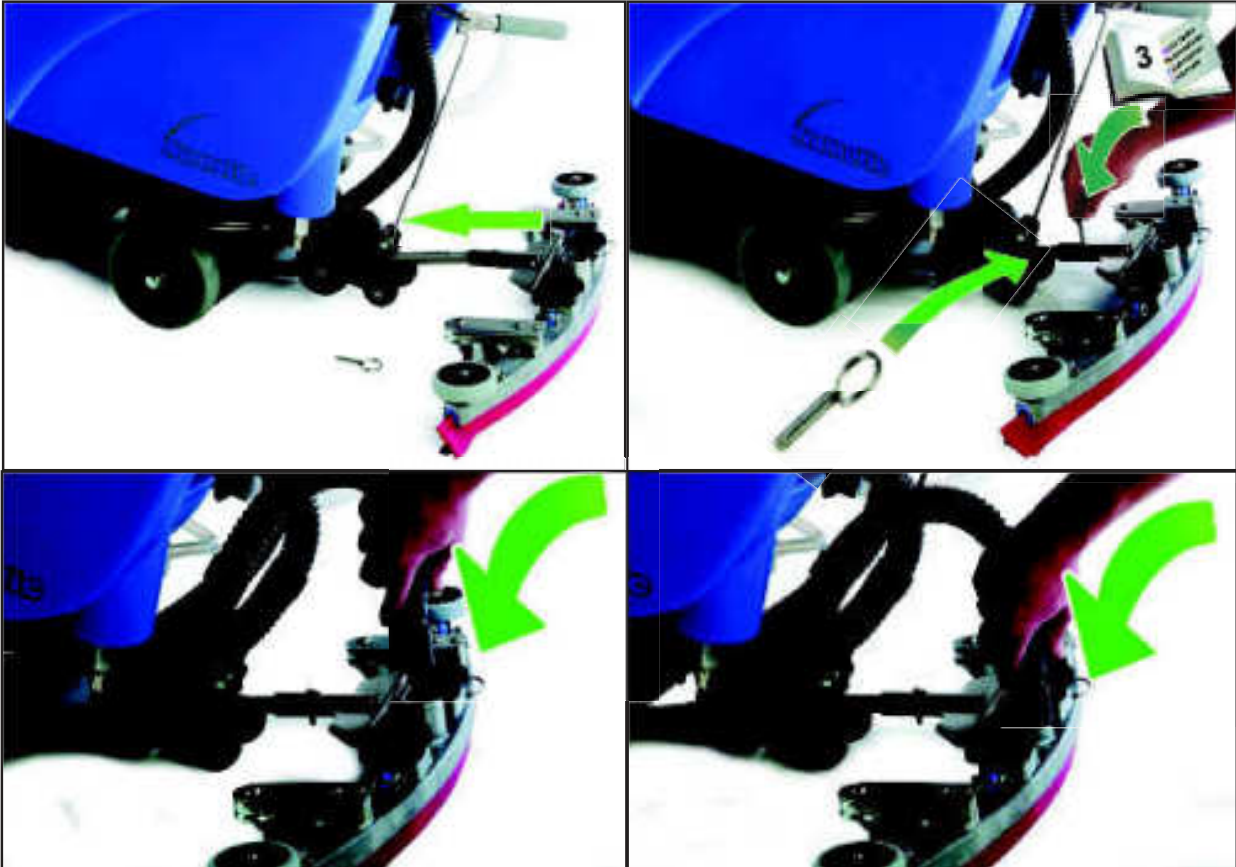

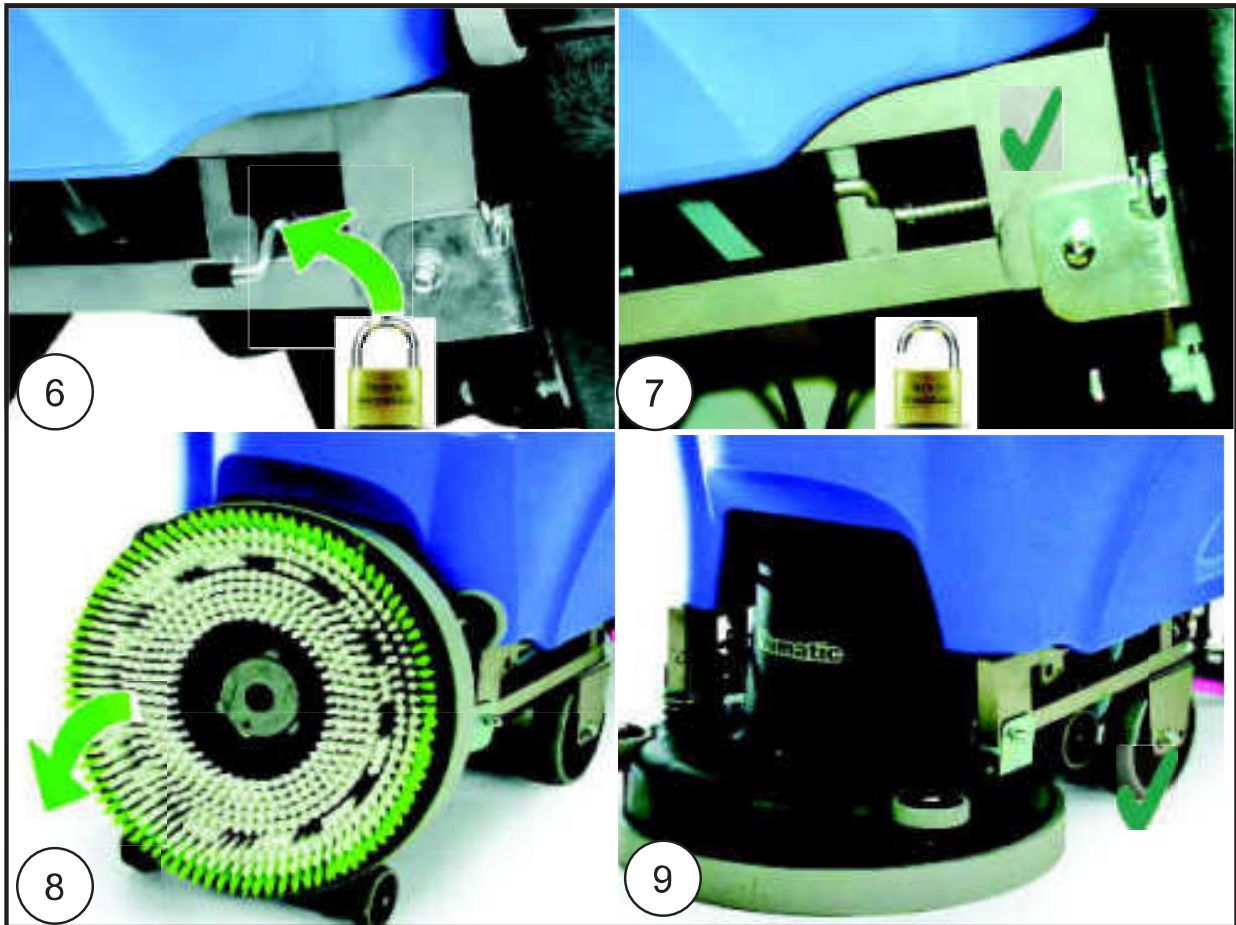
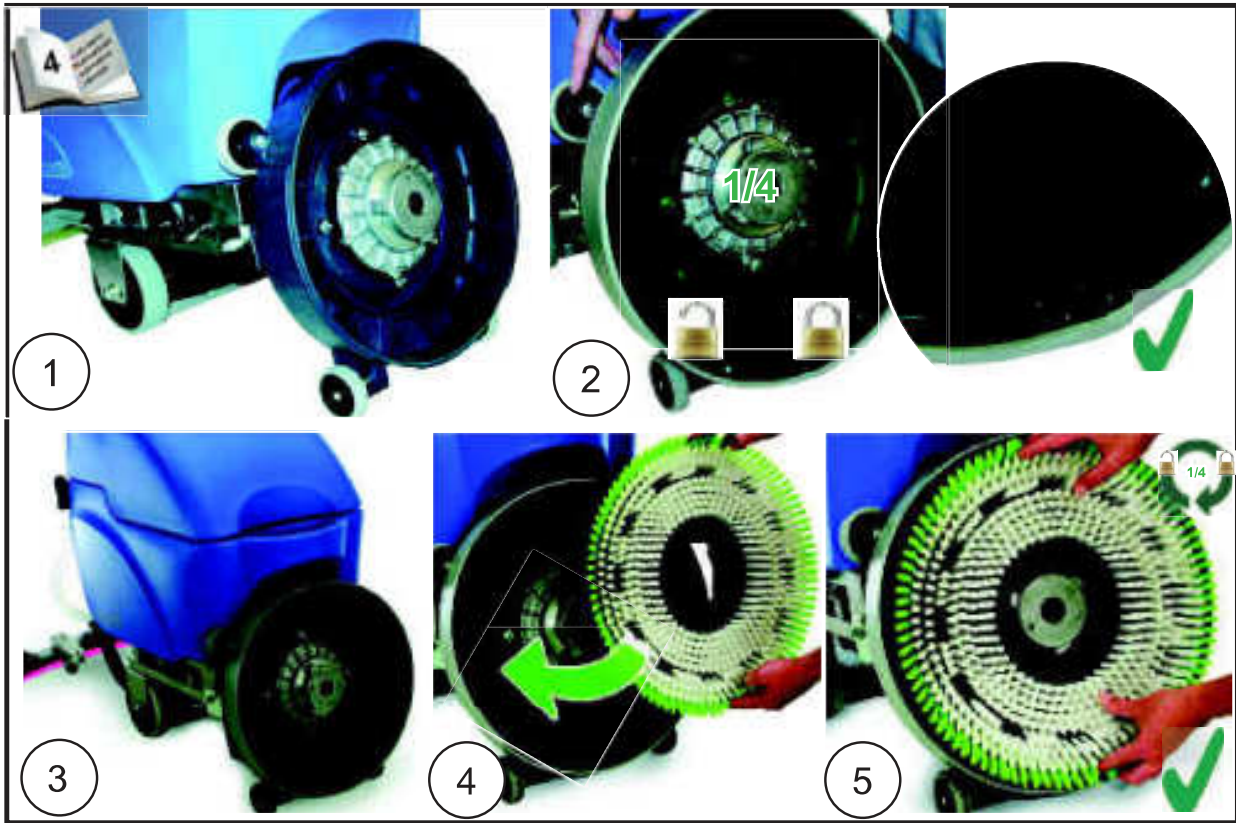

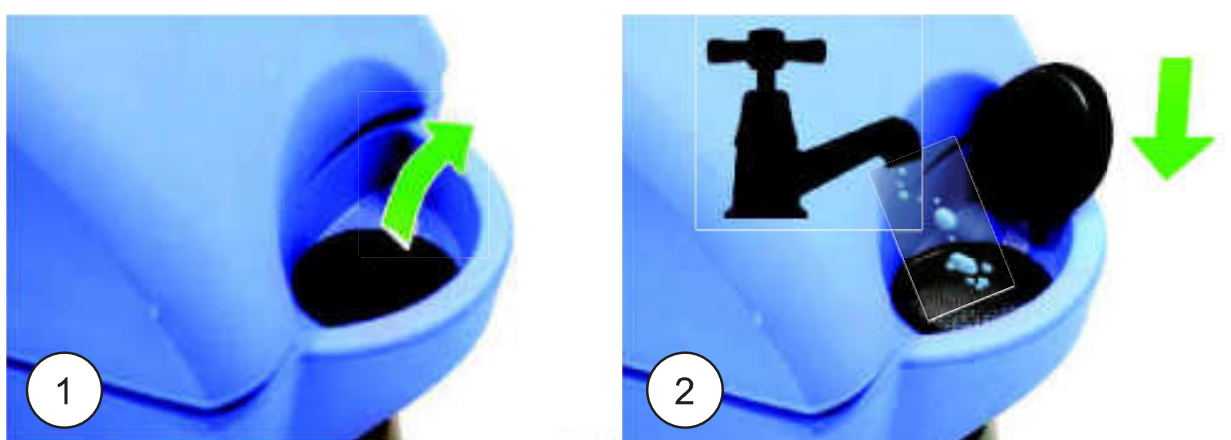
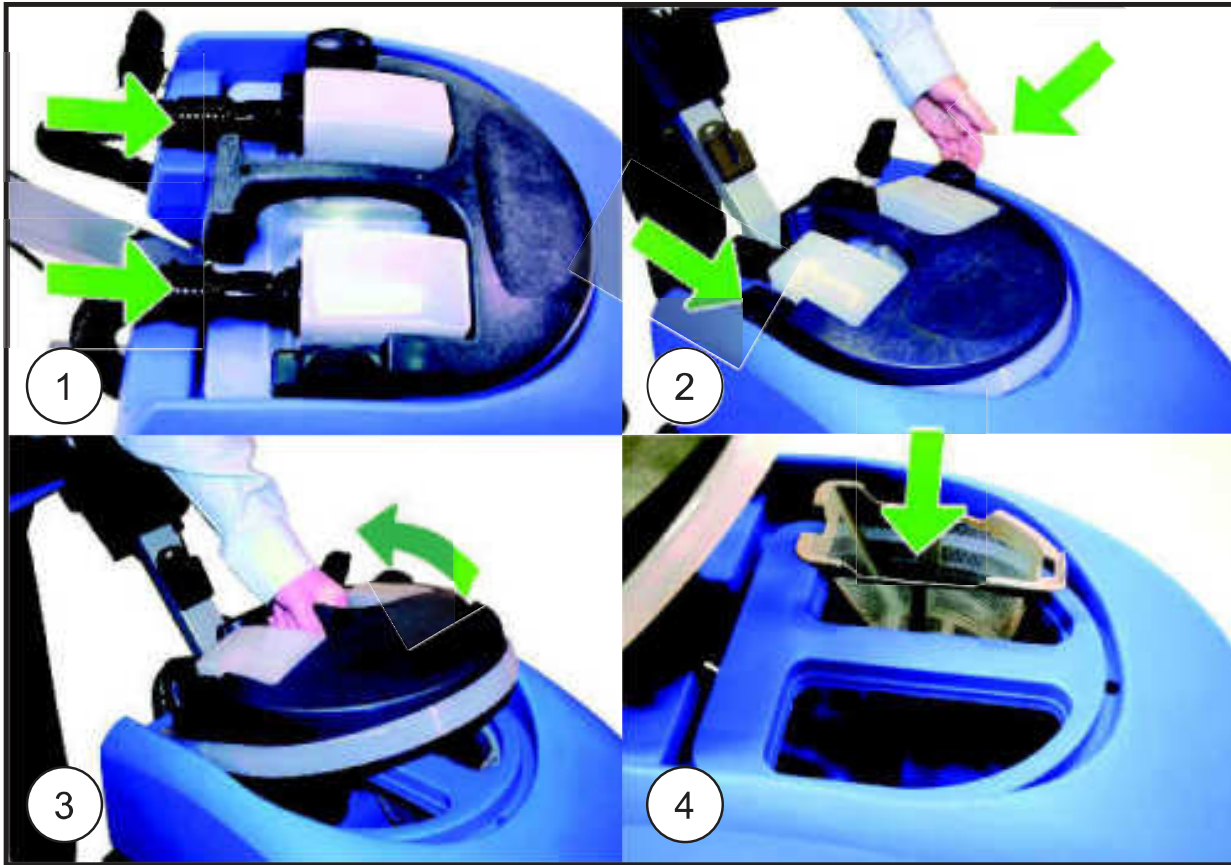
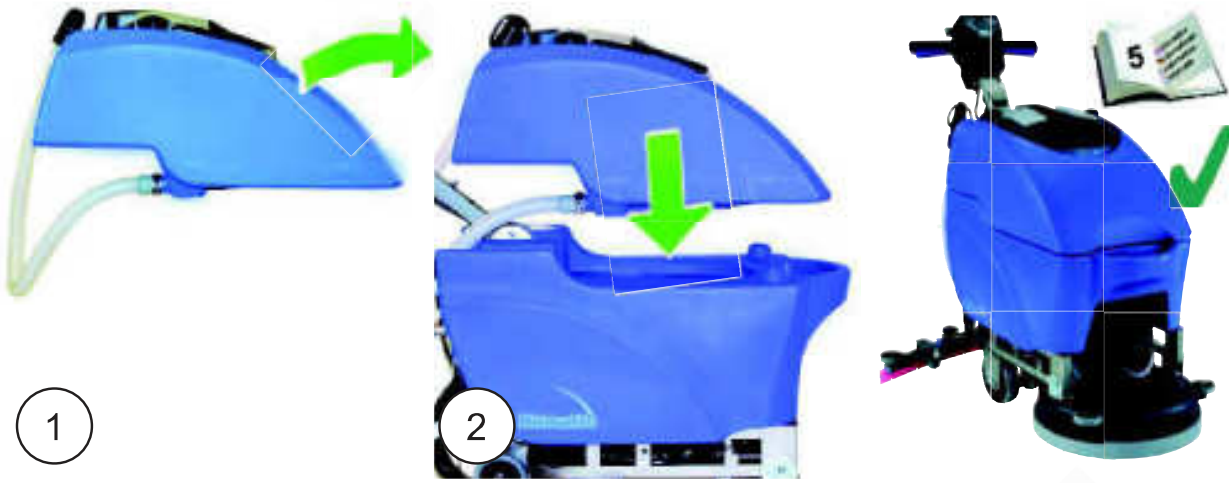

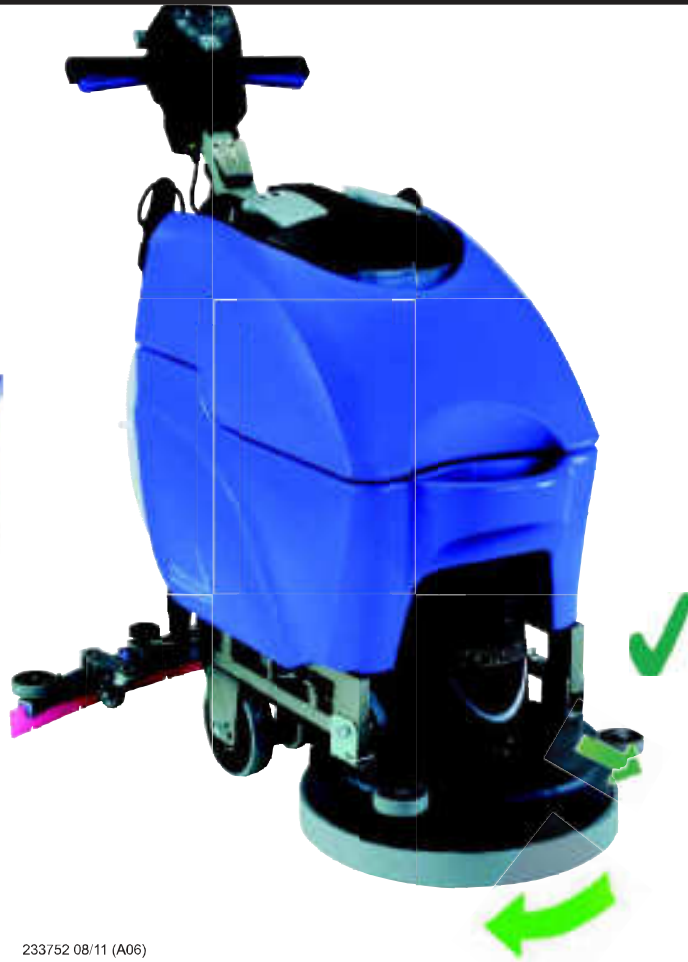
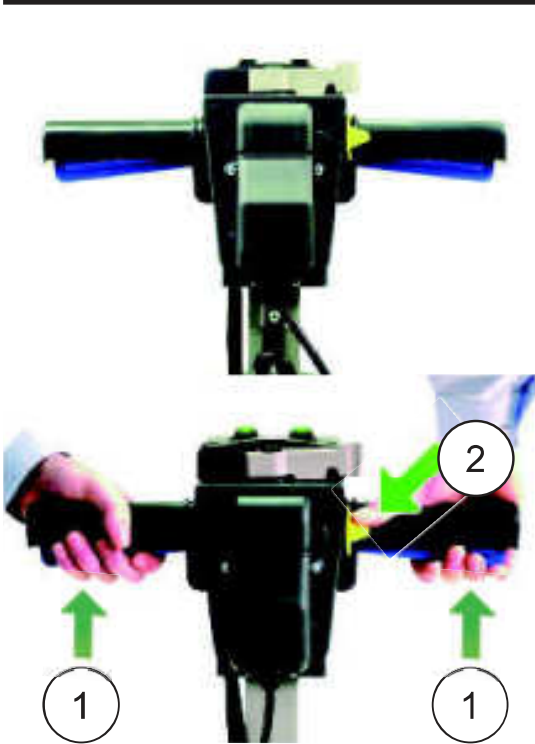
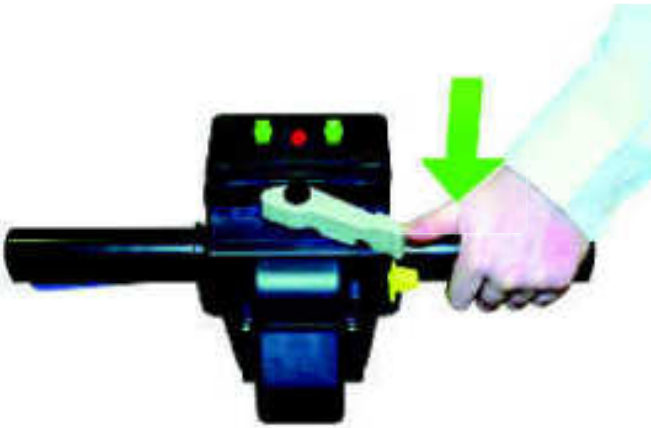

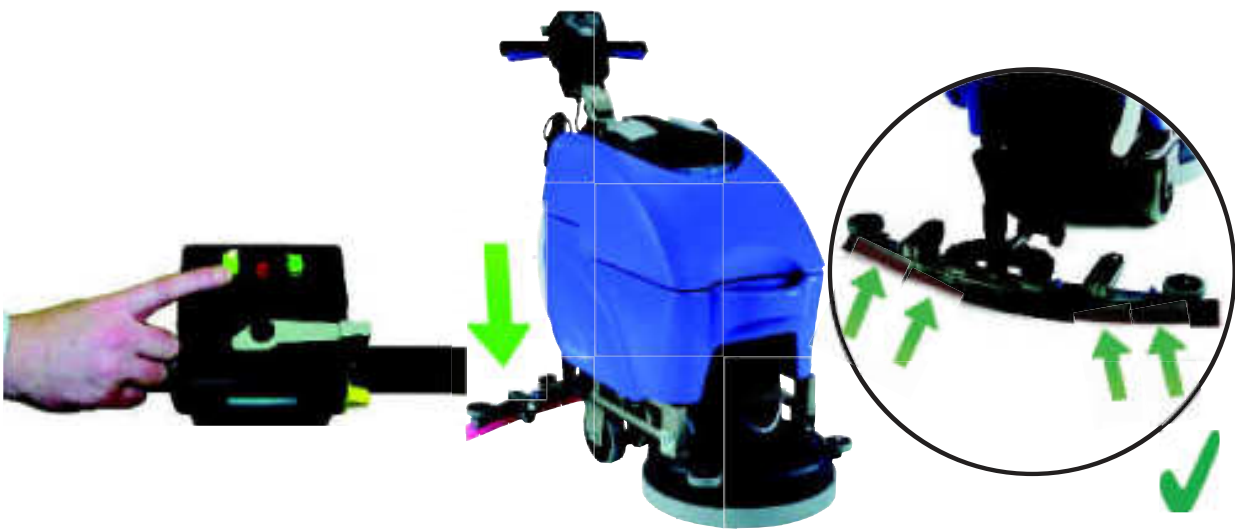
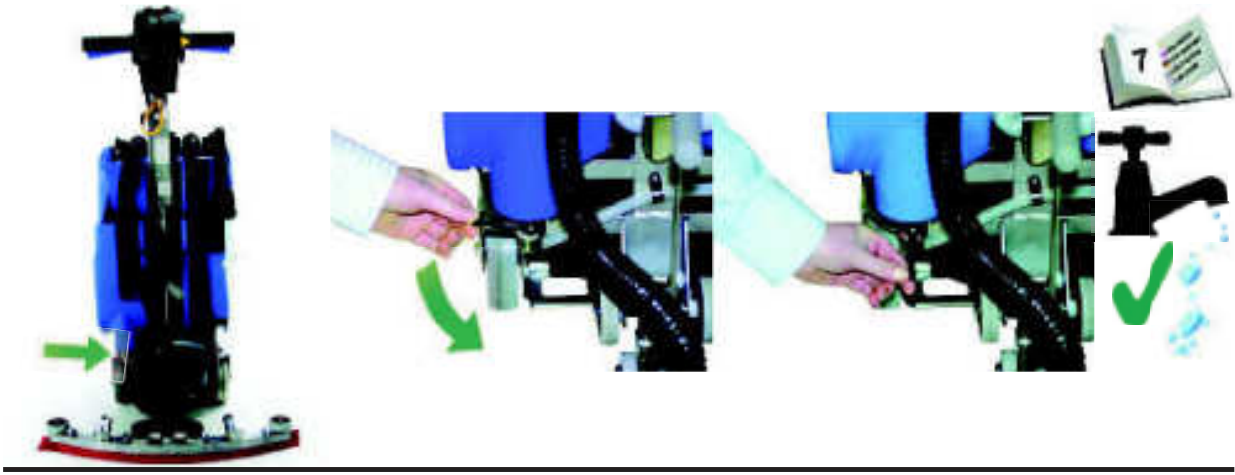

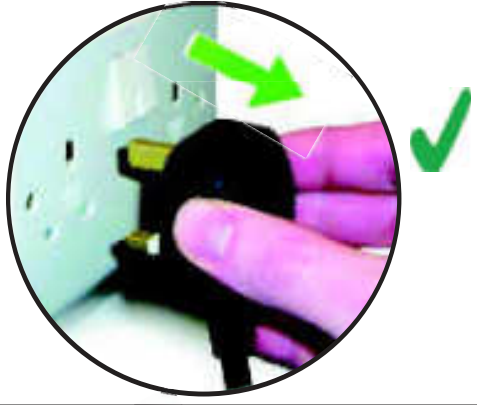
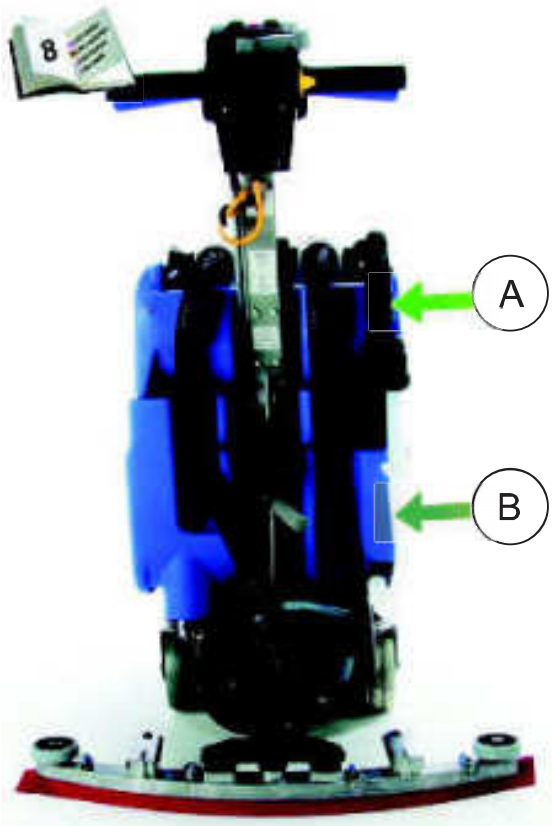

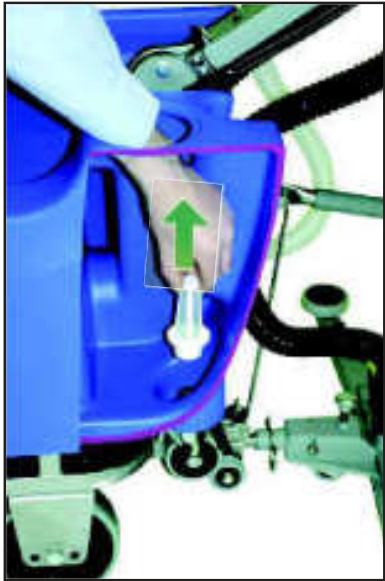

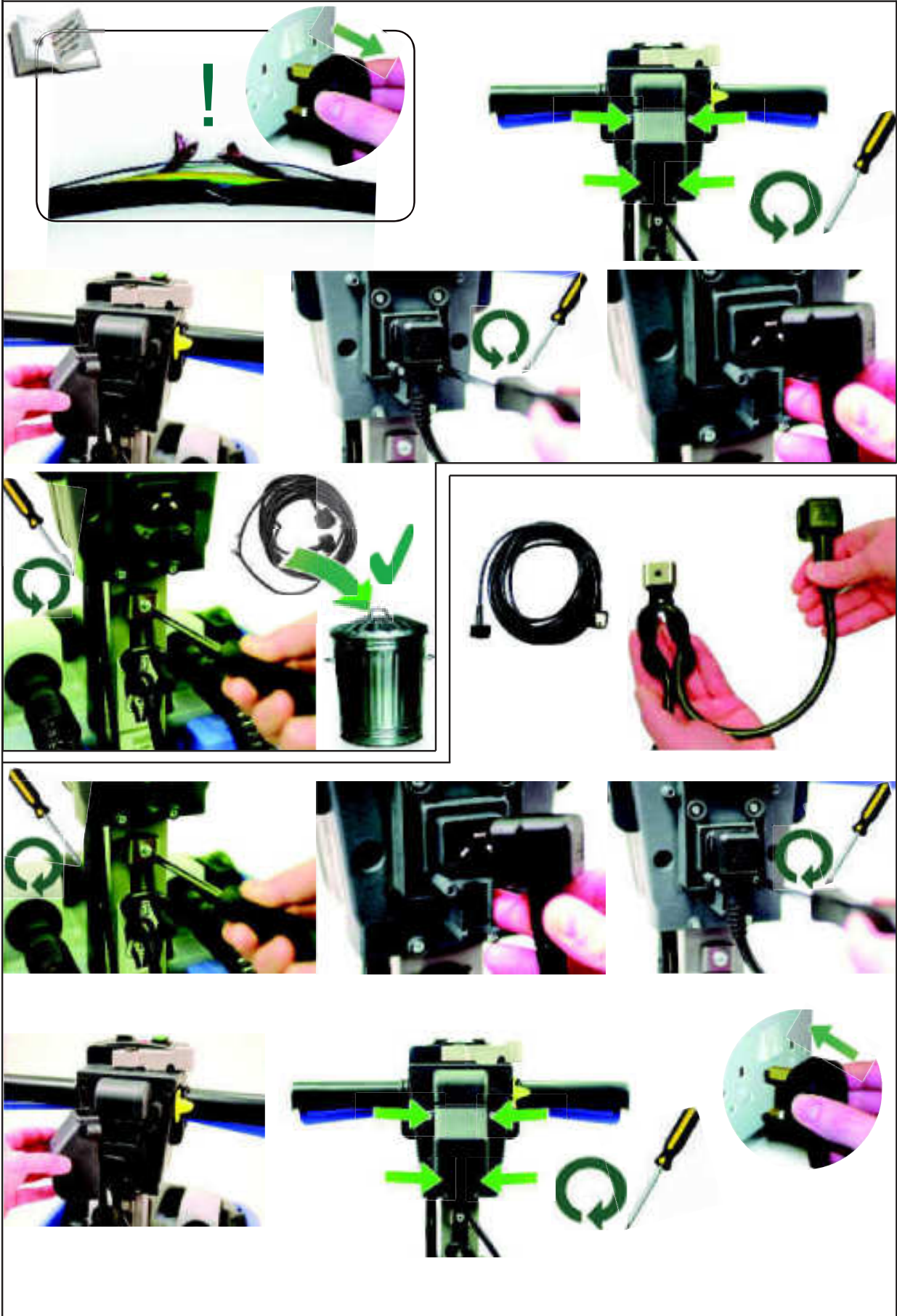



**Changing the Floor Tool Blades, Auswechseln der Blätter des Bodenwerkzeugs
De rubbers van de zuigmond vervangen, Remplacement des lamelles du suceur.**

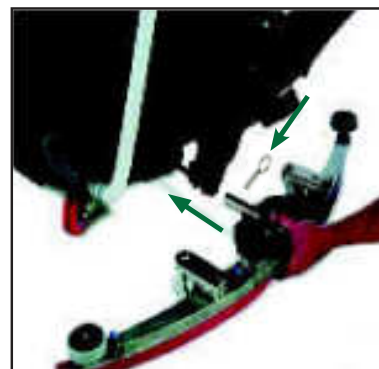
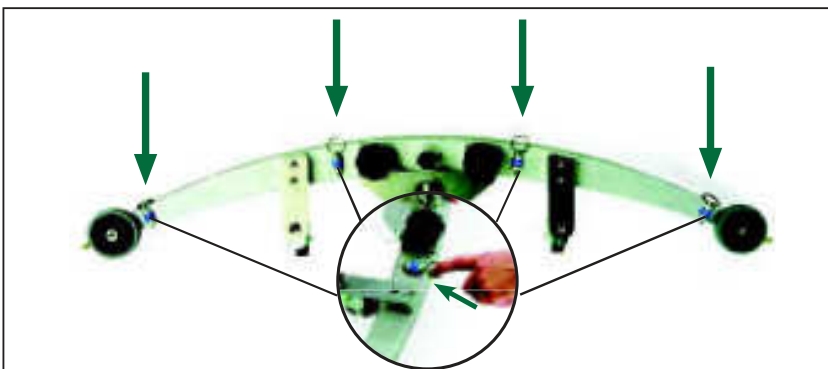
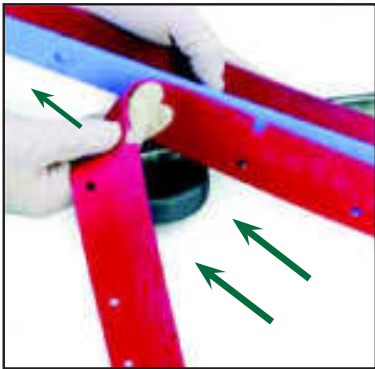
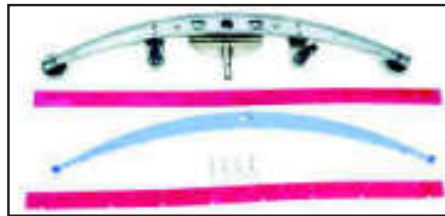
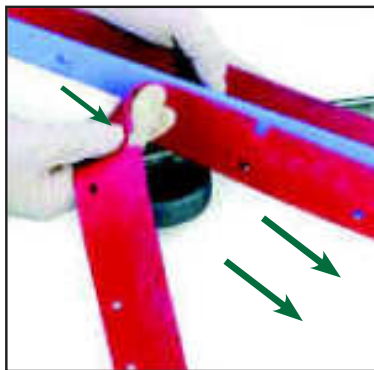
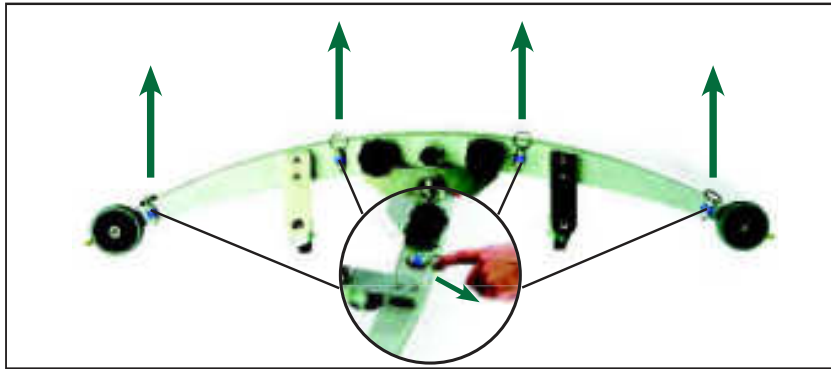
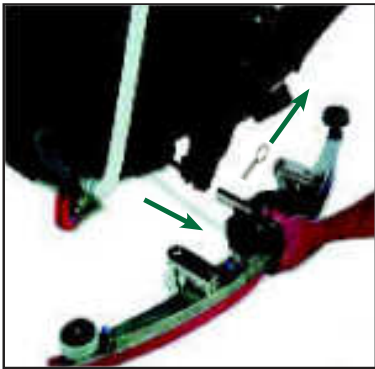



About the Machine

Rating Label

Numatic International Ltd — Company name and address
TT XXXXS — Machine Description
 230V- 50Hz — Voltage Frequency
 2500W — Weight
XXX Kg — Weight
 — Gradient
 — CE Mark
 — WEEE Logo
 100621036 — Machine yr/ wk / serial number

TT XXXXS — Machine Description
WEIGHT XXX Kg MAX — Weight
NOISE WITH VAC 80 dB(A) — Noise Level
HAV 1.3 m/s² — Hand Arm Vibration

WEEE (Waste, Electrical and Electronic Equipment)

Scrubber Dryer Accessories and Packaging should be sorted for Environmentally Friendly recycling.
 Only for EU countries.
 Do not dispose of Scrubber dryer into household waste.
 According to the European directive 2002/96/EC on waste electrical electronic equipment and its incorporation into national law, Scrubber dryers that are no longer suitable for use must be separated collected and sent for recovery in an environmentally friendly manner.

Safety Critical Component

Mains Lead: H05VV-F x 1.5mm² x 3 core

PPE (Personal protective equipment) that may be required for certian operations.

Note:
A risk assessment should be conducted to determine which PPE should be worn.

Caution Floorsign

Hi Viz Jacket

Ear Protection	Safety Footwear	Head Protection	Safety Gloves	Dust/Allergens Protection	Eye Protection	Protective Clothing

TT3450S

Brush Motor	Vac Motor	Power	Sound Pressure	Speed	Brush	Pad
1500W	1000W	220-240v 50Hz 220v 60Hz 120v 60Hz 110v 50Hz	80 dB(A)	50Hz = 150rpm 60Hz = 180rpm	450mm	400mm
Gross Weight Full	Protection Class	Hand Arm Vibration	Dimensions	Net Weight	Cleaning Range	Water Capacity
87 Kg	Class 1	1,4 +/- 0,05ms ²	1150x1030x740	57 Kg	42m	30 L

TT4550S

Brush Motor	Vac Motor	Power	Sound Pressure	Speed	Brush	Pad
1500W	1000W	220-240v 50Hz 220v 60Hz 120v 60Hz 110v 50Hz	84 dB(A)	50Hz = 150rpm 60Hz = 180rpm	550mm	508mm
Gross Weight Full	Protection Class	Hand Arm Vibration	Dimensions	Net Weight	Cleaning Range	Water Capacity
108 Kg	Class 1	1,4 +/- 0,05ms ²	1150x1110x850	68 Kg	42m	40 L



ORIGINAL INSTRUCTIONS
READ MANUAL BEFORE USE

Information for Scrubber Dryer

CAUTION:

Read the instruction manual before using the appliance

NOTE:

This Product meets the requirements of BS EN 60335 - 2.72

This Machine is also suitable for commercial use, for example in hotels, schools, hospitals, factories, shops and offices for other than normal housekeeping purposes.

Care should be taken in the choice of chemicals, detergents and other liquids. Consult your supplier.

Do's and Don'ts:

- DO Ensure only competent persons unpack/ assemble the machine.
- DO Keep your machine clean.
- DO Keep your brushes in good condition.
- DO Replace any worn or damaged parts immediately.
- DO Daily examine the mains lead for damage, such as cracking or aging. If damaged is found, replace the lead before further use.
- DO Only replace the mains lead with the correct Numatic approved replacement part.
- DO Ensure that the work area is clear of obstructions and/ or people.
- DO Ensure that the working area is well illuminated.
- DO Pre - sweep the area to be cleaned.

- DON'T Use steam cleaners or pressure washers to clean the machine or use in the rain.
- DON'T Attempt machine maintenance or cleaning unless the power plug has been removed from the supply outlet.
- DON'T Allow any inexperienced repairs. Contact your nearest service centre.
- DON'T Strain the mains lead or try to unplug by pulling on the mains lead.
- DON'T Leave the brush deck in the lowered position when not in use.
- DON'T Expect the machine to provide trouble free, reliable operation unless maintained correctly.
- DON'T Run the machine over any power cables during operation.

WARNING:

Operators shall be adequately instructed on the use of this machine.

This machine shall be disconnected from its power source (Remove plug from socket outlet.) During cleaning or maintenance or in the event of an accident and when replacing parts or converting the machine to another function.

This machine is not suitable for picking up hazardous dust.

Ensure machine is switched OFF when not in use.

Do not use on slopes - Refer to maximum gradient quoted on the rating label.

Do not use on surfaces having a gradient exceeding that marked on the appliance.

As with all electrical equipment care and attention must be exercised at all times during its use, in addition to ensuring that routine and preventive maintenance is carried out periodically in order to ensure its safe operation.

Failure to carry out maintenance as necessary, including the replacement of parts to the correct standard could render the equipment unsafe and the manufacturer can accept no responsibility or liability in this respect.

When ordering spare parts always quote the model number / serial number specified on the rating plate.

This machine is for indoor use only.

The machine is not to be used or stored outdoors or in wet conditions.

Don't allow the machine to be used by inexperienced or unauthorised operators or without appropriate training.

Only use brushes provided with the appliance or those specified in the instruction manual.

The use of other brushes may impair safety.

A full range of brushes and accessories are available for this product.

Only use brushes or pads which are suitable for the correct operation of the machine for the specific task being performed.

It is essential that this equipment is correct assembled and operated in accordance with current safety regulations.

When using the equipment always ensure that all necessary precautions are taken to guarantee the safety of the operator and any other persons who may be affected.

The 110V / 120V machines have been fitted with a motor overload trip.

If the trip is activated wait 15- to 30 seconds before resetting.

The reset button can be found on the machine handle.

Note:

This appliance is not intended for use by persons (including children) with reduced physical sensory or mental capabilities, or lack of experience and knowledge.

Unless they have been given supervision or instruction concerning the use of the appliance by a person responsible for their safety.

Accessories - Zubehör - Accessoires - Accessoires TT - 3450S

				
 606203	450mm Polyscrub Brush	450mm PPN Schrubbürste	450mm Brosse verte PPE	450mm PolyScrub Schroborstel
 606204	450mm Nyloscrub Brush	450mm Nylon Schrubbürste	450mm Brosse douce Nylon	450mm Nyloscrub Shamponeerborstel
 606306	450mm Longlife Brush	450mm SC Schrubbürste Grün	450mm Brosse Verte Longlife	450mm Longlife Borstel
 606202	450mm Union Mix Brush	450mm Union Mix Bürste	450mm Brosse Union Mix	450mm Union Mix Borstel
 606206	400mm Pad Drive Board	400mm Nuloc Treibteller	400mm Plateau support Disque	400mm Nuloc aandrijfschijf
 606157	Optional Polyurethane Floor Tool Blade Set	Optional PU Ersatzgummilippen set (650mm) 2 Stück	Facultatif Lammelles pour suceur 650mm pour TTV	Optionele PU Vervangingset rubbers (2 stuks)
 606196	Recommended Linatex Floor tool Blade Set	Empfohlene Linatex Ersatzgummilippen set (650mm) 2 Stück	Recommandées Linatex Lammelles 650mm	Aanbevolen Linatex Vervangingset rubbers (2 stuks)











Spares - Ersatzteile - Pièces Détachées - Reserve Onderdelen TT - 4550S

				
577306	Top Tank	Schmutzwassertank	Réservoir Supérieur	Vuilwatertank
577310	Bottom Tank	Frischwassertank	Réservoir Inférieur	Schoonwatertank
577251	Separator	Separator	Séparateur	Verdeler
229282	Filter Cap	Einlauffilter	Bouchon de remplissage	Vuldop
206265	Barrel Filter	Kerzenfilter	Filtre conique	Filter
207000	Basket Filter	Grobschmutzfilter	Panier filtrant	Filter
206697	Vac hose	Saugschlauch Saugmotor	Flexible d'aspiration	Slang
606696	Floor Tool Hose	Saugschlauch Abstreifer	Flexible coté suceur	Slang
303768	Dump Hose Top	Ablaufschlauch oben	Flexible de vidange supérieur	Slang
303641	Dump Hose Bottom	Ablaufschlauch unten	Flexible de vidange inférieur	Slang
606216	Floor Tool	Abstreifer	Capteur / Suceur	Zuigmond
206953	Detent Pin	Arretierstift	Goupille	Borgpennen
226008	Stress Relief	Zugentlastung	Guide cable	Trekontlasting
236012	Cable UK	Zuleitung	Câble UK	Snoer
236132	European Cable	Zuleitung mit Schuko-Stecker	Câble Euro (prise européenne)	Snoer (europese stekker)
236020	Swiss Cable	Zuleitung Schweiz	Câble Suisse	Snoer Zwitserland
236028	Cable USA	Zuleitung	Câble USA	Snoer
204080	Wheel	Rad grau, 160 mm Ø	Roue	Wiel
120V: 303893	Brush Motor	Bürstenmotoren	Moteurs de brosse	Borstelmotoren
230V: 303883	Brush Motor	Bürstenmotoren	Moteurs de brosse	Borstelmotoren
120V: 577734	Deck	Bürstendeck	Carter	Borstelhuis
230V: 577733	Deck	Bürstendeck	Carter	Borstelhuis
UK: 577262	Handle	Handgriff	Poignée	Handel
EU: 577266	Handle	Handgriff	Poignée	Handel
USA: 577282	Handle	Handgriff	Poignée	Handel
120V: 577221	Vac Pod	Saugpumpenmotor	Moteur d'aspiration	Zuigmotor
230V: 577219	Vac Pod	Saugpumpenmotor	Moteur d'aspiration	Zuigmotor

Accessories - Zubehör - Accessoires - Accessoires
TT - 4550S

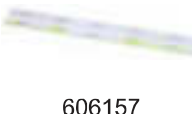
				
 606028	550mm Polyscrub Brush	550mm PPN Schrubbürste	550mm Brosse verte PPE	550mm PolyScrub Schroborstel
 606550	550mm Nyloscrub Brush	550mm Nylon Schrubbürste	550mm Brosse douce Nylon	550mm Nyloscrub Shamponeerborstel
 606551	550mm Longlife Brush	550mm SC Schrubbürste Grün	550mm Brosse Verte Longlife	550mm Longlife Borstel
 606115	550mm Union Mix Brush	450mm Union Mix Bürste	450mm Brosse Union Mix	450mm Union Mix Borstel
 606034	500mm Pad Drive Board	500mm Nuloc Treibteller	500mm Plateau support Disque	500mm Nuloc aandrijfschijf
 606157	Optional Polyurethane Floor Tool Blade Set	Optional PU Ersatzgummilippen set (650mm) 2 Stück	Facultatif Lammelles pour suceur 650mm pour TTV	Optionele PU Vervangingset rubbers (2 stuks)
 606196	Recommended Linatex Floor tool Blade Set	Empfohlene Linatex Ersatzgummilippen set (650mm) 2 Stück	Recommandées Linatex Lammelles 650mm	Aanbevolen Linatex Vervangingset rubbers (2 stuks)



Wiring Diagram - Schaltplan - Schéma électrique - Bedradingsschema WD - 0210 (A13) 16.9.2010

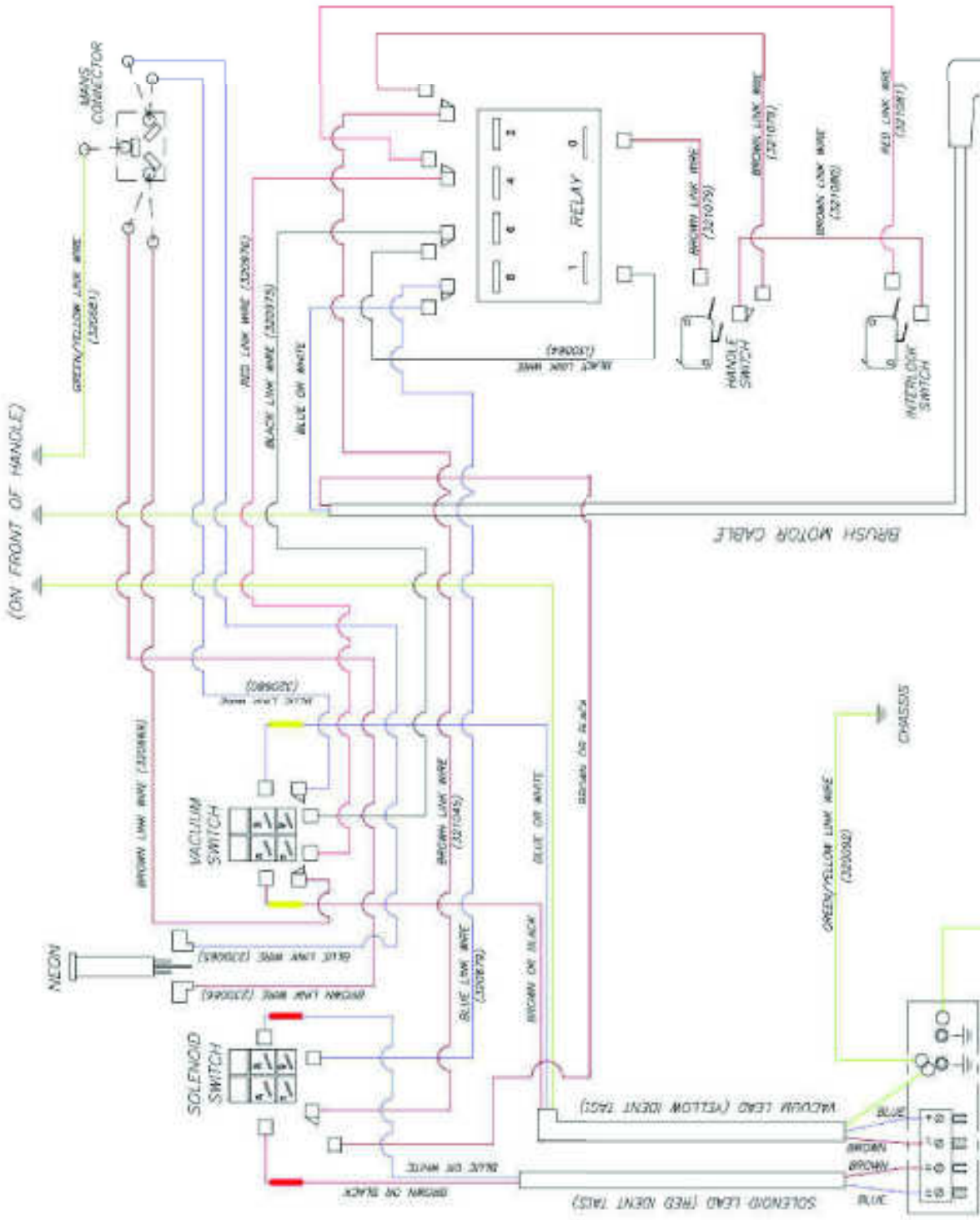

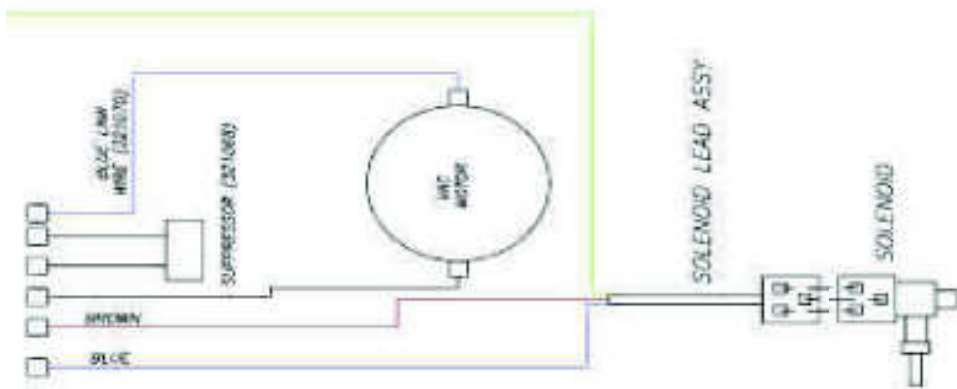
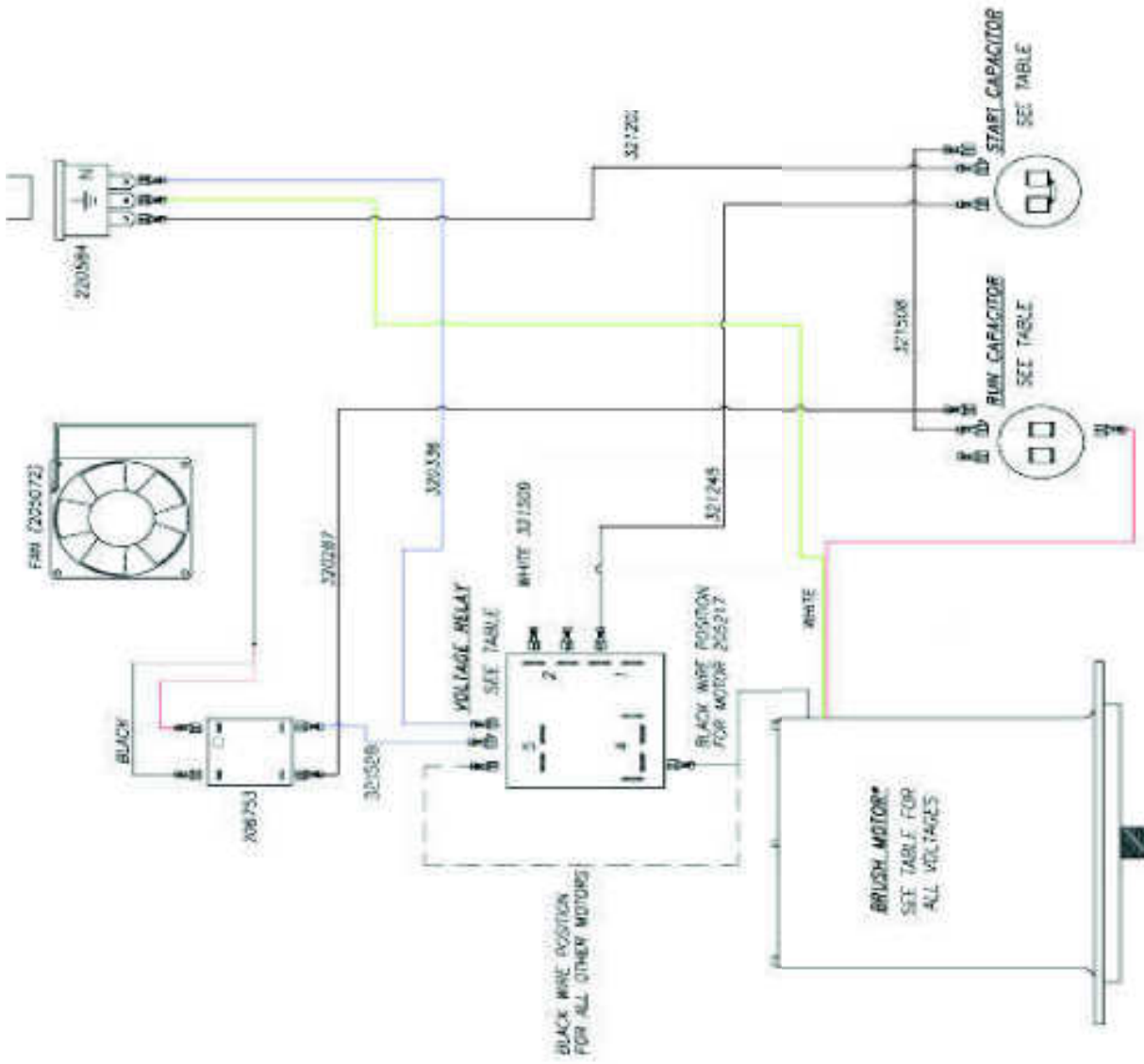

MOTOR*	START CAP**	RUN CAP**	V/RELAY**
205217 COMBINED INDUCTION MOTOR 4 POLE 230V 50Hz	208265	220876	206823
205219 COMBINED INDUCTION MOTOR 4 POLE 220V 60Hz	208265	220876	206823
205220 COMBINED INDUCTION MOTOR 4 POLE 120V 50Hz	208210	208211	206812
205221 COMBINED INDUCTION MOTOR 4 POLE 110V 50Hz	208210	208219	206822

DRW-10368 17.8.11 (A01)

110V 50Hz UK Industrial machines.

