

Spotnails Model Stock Code 5

SPOTNAILS LTD

parts list for model AF mallet tool

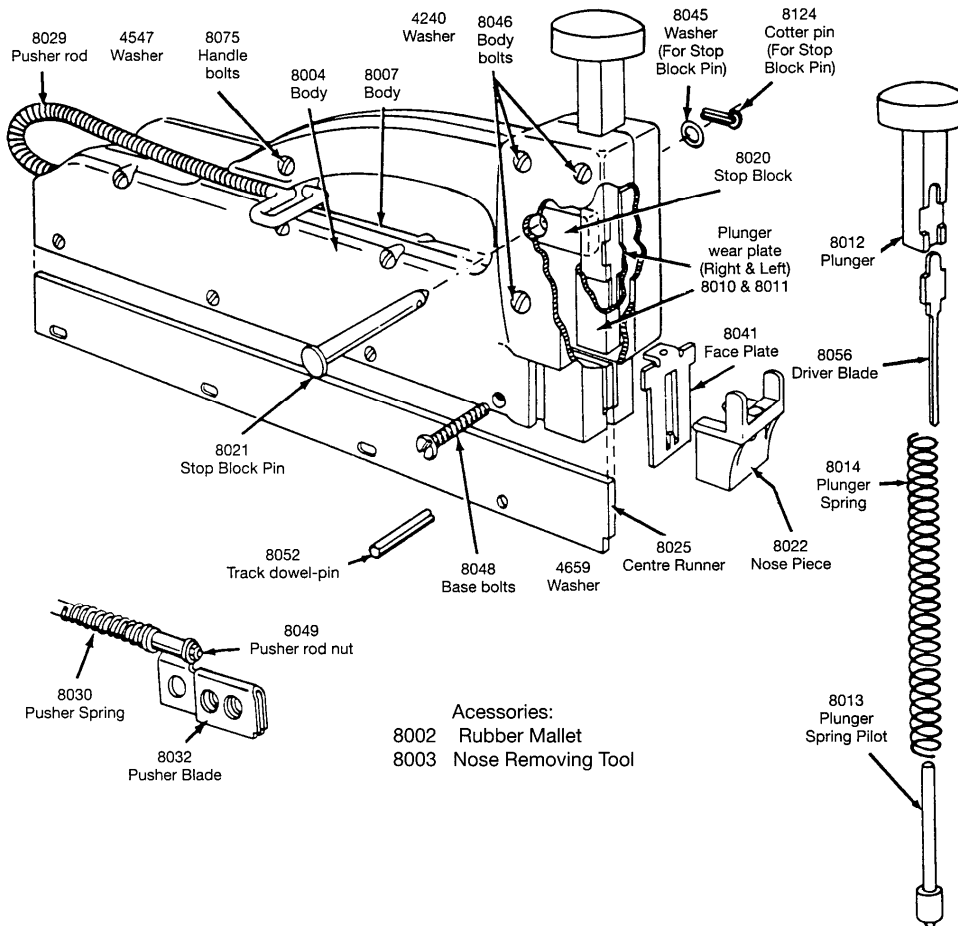

Accessories:

- 8002 Rubber Mallet
- 8003 Nose Removing Tool

operating instructions

The Model AF Spotnailer takes three lengths of staple $\frac{5}{8}$ " long (55DC), $\frac{3}{4}$ " long (66DC), $\frac{7}{8}$ " long (77DC).

TO LOAD THE SPOTNAILER WITH STAPLES

1. Remove the pusher from the tool.
2. Feed 3 sticks of staples into the tool over the centre runner.
3. Replace the pusher and hook into position.

THE TOOL IS NOW READY FOR USE

Grip the tool firmly and place on the workpiece. Take the rubber mallet and give the plunger ONE sharp blow, sending the plunger fully home.

Do not tap and bang with the mallet as this will double feed the staples causing a staple to jam. The most common staples used for fastening hardboard underlayment is the 77DC Spotstaple (Divergent Chisel), the shorter staples being used when hardwood floors are encountered.

NOTE:

When driving staples for flush fitting applications (e.g floor underlayment work) the blade should be ground to suit.

Pneumatic powered tools are also available for driving these staples, together with a whole range of nailing, stapling and bradding equipment.

PLEASE ASK FOR DETAILS

SPOTNAILS LTD

maintenance instructions model AF mallet tool manually operated

Staplers

We have tried to make each new Spotnailer more trouble-free than the last. But even the finest tool has moving parts that will wear. For this reason, we have made our tools easy to disassemble and replace the few parts which occasionally may be required. This is a sturdy tool, built to take a pounding. If you will follow the simple instructions, your tool should give you many years of service. **Never** use the nose of a Spotnailer to hammer down a partially driven fastener. Never bang the end of your Spotnailer against concrete or wood to jar out fasteners stuck in the track. Abusing your Spotnailer in either of these two ways may damage it beyond repair. Allow only a competent mechanic to attempt repairs. Any defective parts will be replaced without cost providing the damage was not caused by the user or by normal use.

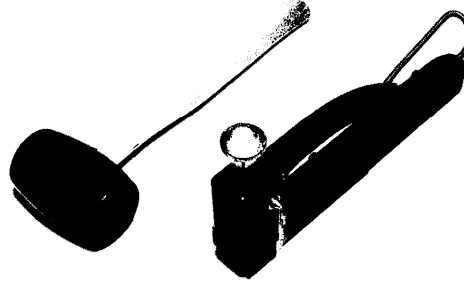

Please return any inoperative tool with a label describing the difficulty to our factory for fast repair. Let your Spotnails representative know of any special problem you have, and also let him know of your successes. We will be interested.

TO REMOVE AND PREVENT JAMMED FASTENERS

1. Unhook pusher rod and empty tool to rear.
2. Remove the nosepiece using the special nose removing tool accessory. If this is not available then place tool with nosepiece overhanging the edge of workbench or piece of 2 x 4. Use a punch, nail-set, or screw driver to tap the nosepiece down until it slips off the tool. Do not tap nosepiece directly with hammer, as hammer-head may crack plastic body.
3. Remove jammed fastener and replace nosepiece by gently tapping back on. To take up shock of tapping, hold tool in hand. Otherwise, shock may crack plastic.

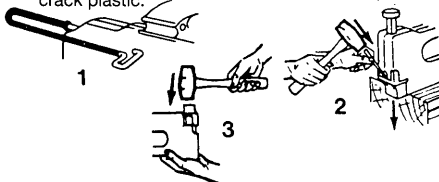

4. Slide pusher rod back and forth in empty tool to be sure it slides freely. Check pusher blade. If it binds it must be straightened or replaced.
5. Slide pusher rod all the way into empty track and hook into socket. Jamming of last fastener indicates that the pusher rod spring is caught on tool housing taking tension off fastener. Bend spring and pusher rod back into shape or replace with new part.

NOTE:

Jamming is usually caused by a damaged pusher rod, blade, or spring. If your Spotnailer feeds properly it will drive without jamming.

TO REPLACE DRIVER BLADE

Even the finest blades will wear out if you drive thousands of fasteners a day, month after month. Replacement is simple and easy.

1. Unhook pusher rod and empty tool to rear.
2. Remove the cotter pin and tap out stop block pin.

3. Tip up nose of tool and depress plunger with your hand as far as it will go. You will hear a click as the stop block slides clear.

CAUTION:

Never hold hand under nosepiece!

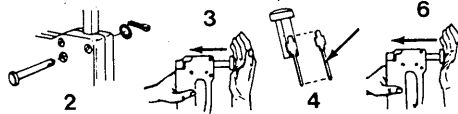

4. Pull out plunger assembly, remove old driver blade and attach new driver blade.
 5. Replace plunger assembly, be sure ridge on driver blade is facing forward.
 6. Depress plunger all the way. Tip tool nose down and slowly release plunger. You will hear a click as the stop block slips into place, locking in the plunger.
- CAUTION:**
Never hold hand under nosepiece!
7. Replace plunger stop block pin, washer and cotter pin. Spread cotter pin.
 8. **IMPORTANT:**
If there is any possibility that broken parts of the driver blade may still be in the nosepiece, be sure to remove nosepiece and remove any jammed fasteners or driver blade parts.

TO REPLACE CENTRE BAR

1. The centre bar of your Spotnailer seldom needs replacing.
2. If an accident damages your centre bar requiring replacement, remove the nose piece as illustrated in the description of removing jammed fasteners. Also remove plunger as shown in the description of replacing driver blades. Then remove body bolts and take the right and left parts of the tool apart.

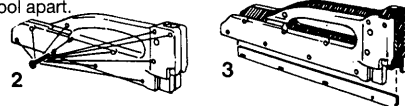

3. Remove and replace track and re-assemble tool.