

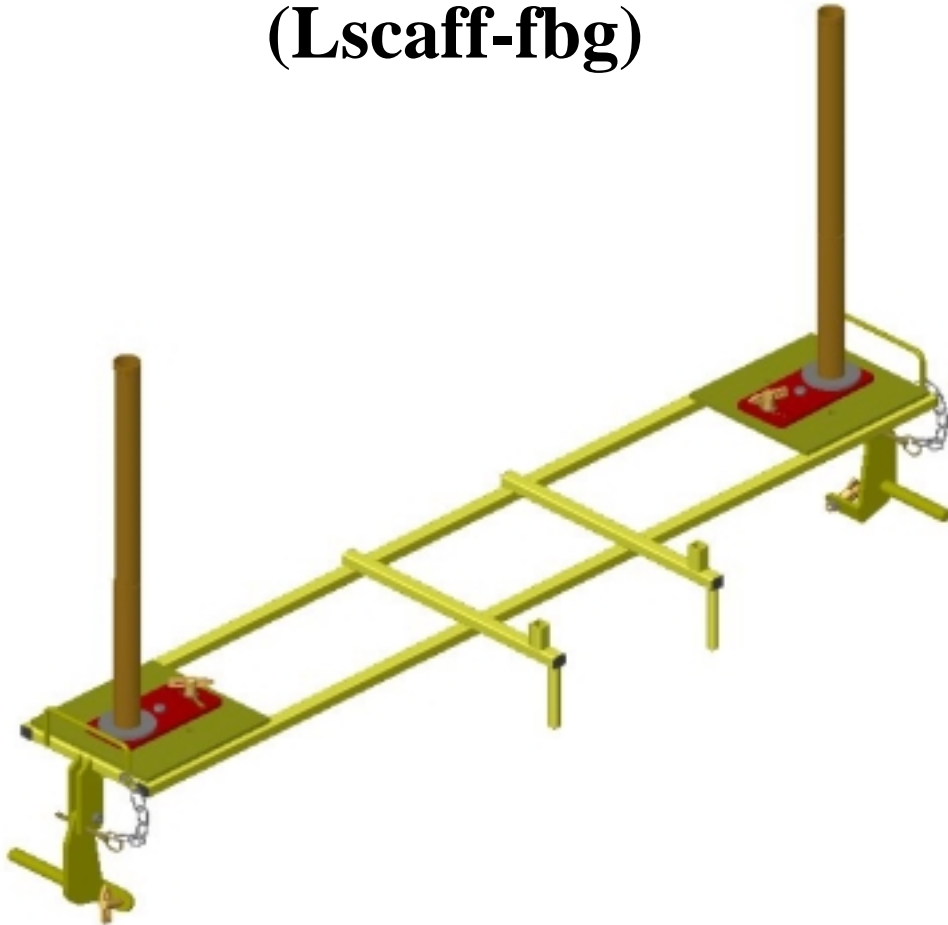

For further information contact our offices:

Rotamag Track Equipment
41 Catley Road, Darnall, Sheffield, S9 5JF
Tel: (0114) 2911020
Fax: (0114) 2618186

SCAFFOLD ATTACHMENT FOR LINK TROLLEY (Lscaff-fbg)



OPERATIONS MANUAL AND SPARE PARTS LIST

INDEX

Section	Description
1.	Introduction
2.	Using Your Scaffold Attachment
2.1	Connecta-Trolley Location
2.2	Scaffold Attachment Location
2.3	Location of Scaffolding
3.	Operating Your Scaffold Trolley
3.1	Movement Whilst Not In Use
3.2	Platform movement
4.	Removing The Scaffolding
5.	Removing The Scaffold Attachment

Maintenance Instructions & Parts Breakdown

6.	Preventive Maintenance
6.1	Daily / Pre-use Inspection
6.2	Annual Inspection and Maintenance
7.	Corrective Maintenance
8.	Parts Breakdown
8.1	Complete Scaffold Attachment
8.2	Rail Hooks
8.3	Swivel Bracket

1. Introduction

ROTAMAG would like to congratulate you on the purchase of your new **Scaffold Attachment**. This is a specialist product which is built to the highest quality and has a number of unique features to make it the best solution for your permanent way maintenance requirements.

The **ROTAMAG Scaffold Attachment** has been designed to fit to the **ROTAMAG Connecta-Trolley** and provide a safe stable mounting aid for attaching scaffold.

It is constructed from high grade materials and components that are manufactured and assembled by highly trained engineering staff.

The **ROTAMAG Scaffold Attachment** is capable of supporting various lengths of scaffold when used with the specific brake bar.

The **ROTAMAG Scaffold Attachment** is simple and safe to use if these instructions are followed carefully.

2. Using Your Scaffold Attachment

2.1 Connecta - Trolley Location

With two Connecta-Trolleys located on the rail, connect the trolleys with the desired brake bar to the brake levers as shown. (See Diagram Below).

Once connected, set the brake bar to the correct length for the scaffold platform to be used.

**Brake bar location
Points**

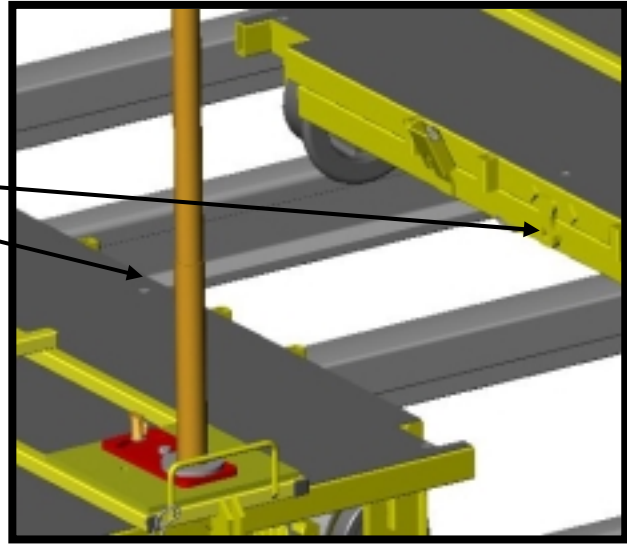

2.2 Scaffold Attachment Location

Carefully lower the Scaffold Attachment on to the Connecta-Trolley ensuring the two location shafts enter the location points on the trolley.

Please ensure the trolley location points on the outer face of the trolley are used. (See Diagram Below)

**Trolley Location
Points**

Location Shafts

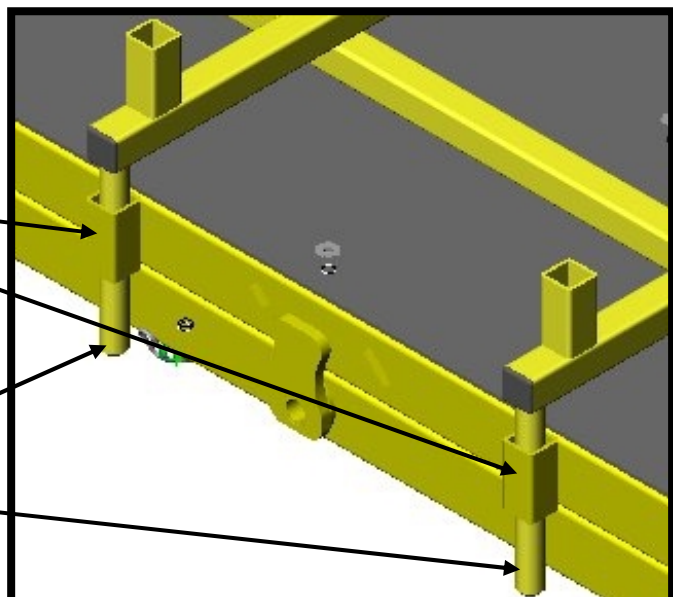

2.3 Location of Scaffolding

Loosen the locking nuts at both ends to allow the swivel plates to rotate. Carefully lower the vertical section of the scaffold tube on to the scaffold location leg. (See Diagram Below)

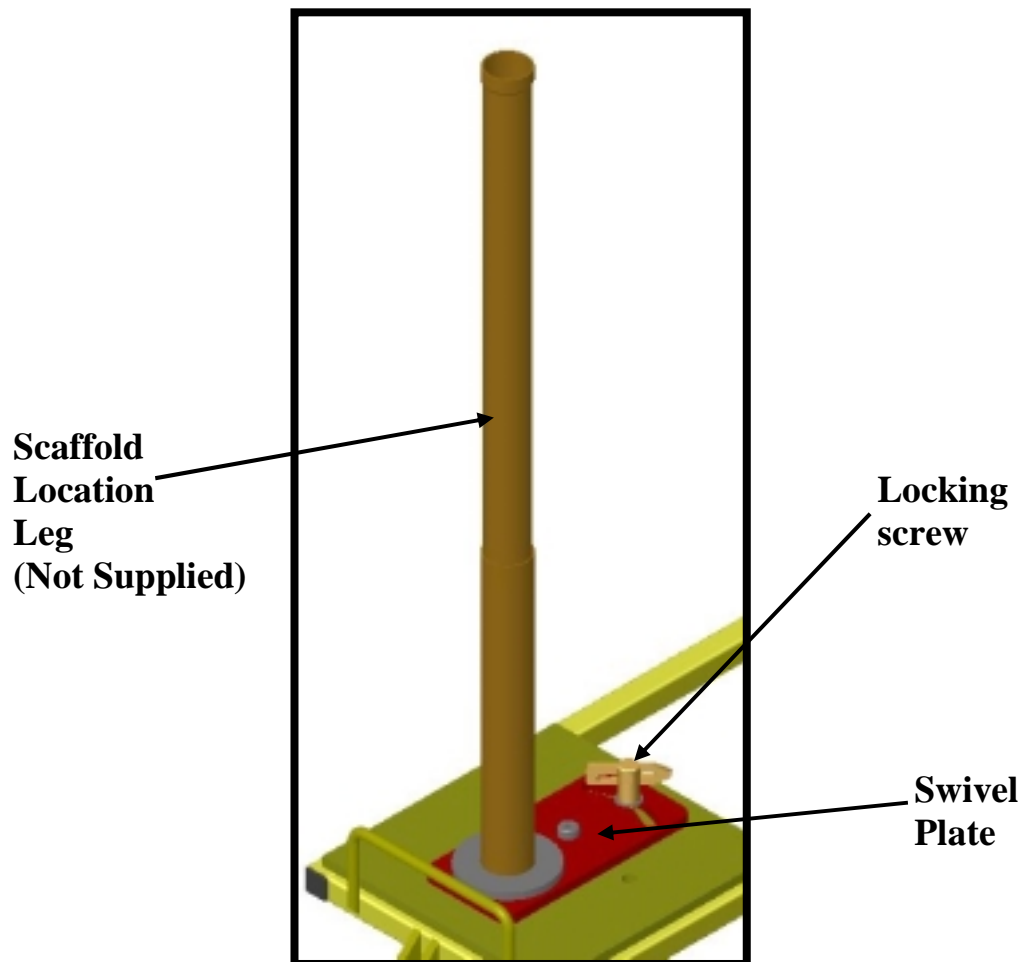

Once the four vertical scaffold sections are erected and locked in place the lateral members should be clipped into position and the longitudinal bars assembled.

At this stage all the locking mechanisms should be tightened and found to be secure. The scaffolding can then be progressively built up, ensuring that each level is safe and secure before progressing to the next.

3. Operating Your Scaffolding Trolley

3.1 Movement whilst not in use

In order to move the trolley any distance whilst not in use, the four rail hooks should be in the up position and locked out of the way using the locking pin. (See Diagram Below)

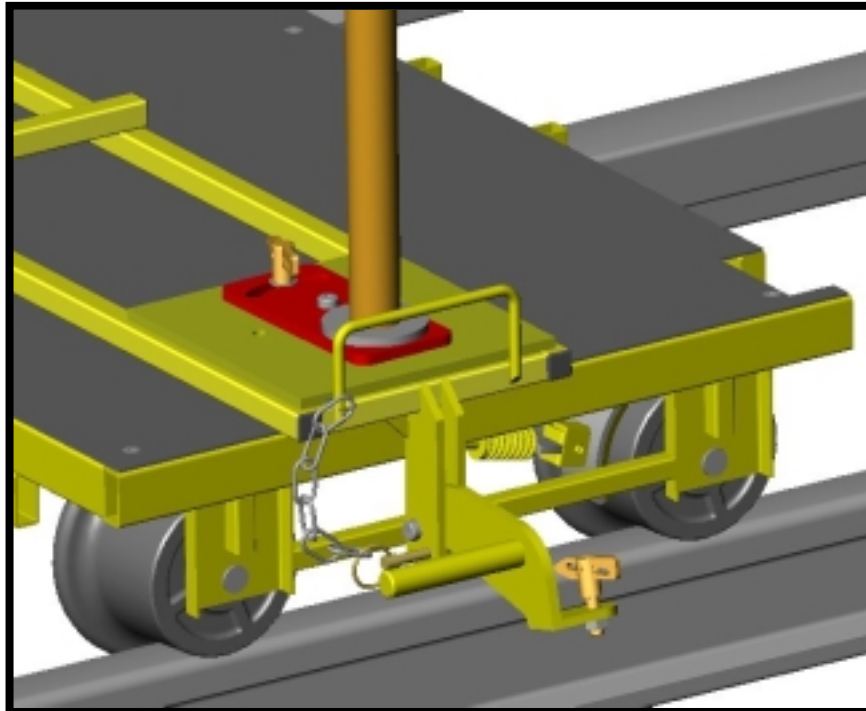

Once all the rail hooks are locked in the up position, the trolleys are ready to be moved. Fit the Connecta-Trolley handle at the rear of the trolley and locate the brake lever.

Operate the brake release lever and push the trolleys to the desired location.

3.2 Platform Work

The platform has a safe working load of 275Kg. Operators should ensure that neither the scaffold trolley or scaffold systems safe working loads are exceeded.

Before the operator uses the scaffold platform he must:-

Check that all the rail hooks have been lowered, locked in position and the locking mechanisms have been adjusted to ensure that all the locking mechanisms are in contact with the rail. (See Diagram Below)

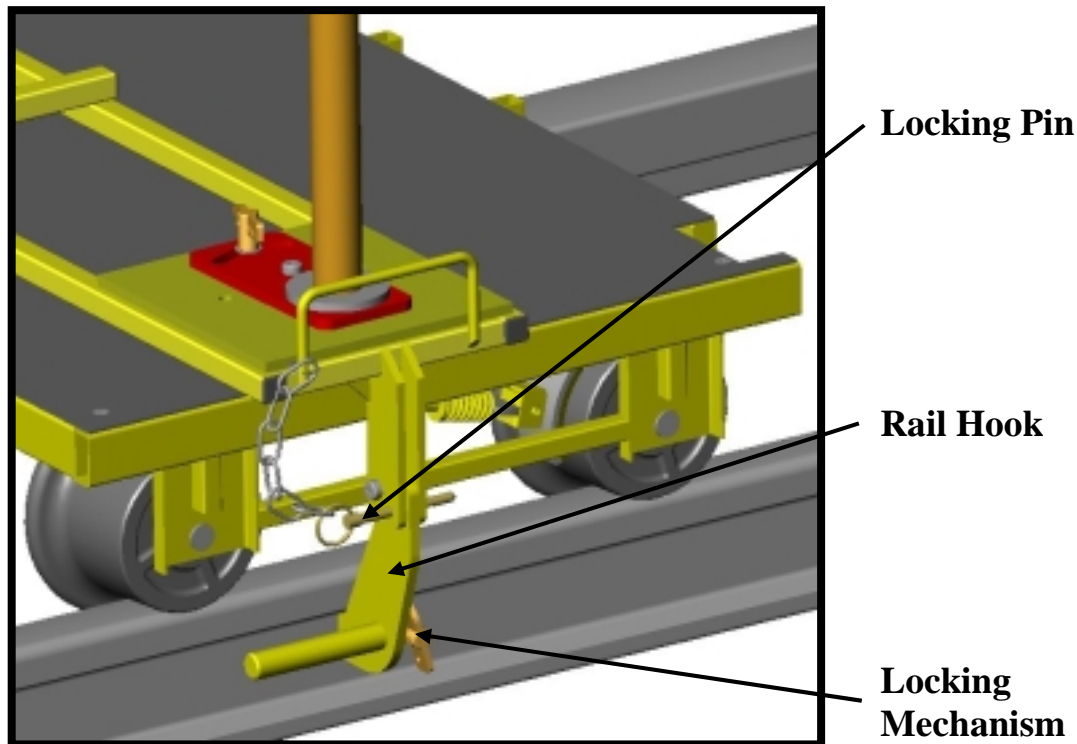

Check that the fail safe brake is correctly applied to both trolleys.

Check that all the scaffolding is located correctly onto the scaffold attachment and that the scaffold attachment is located correctly to the Connecta-Trolley.

Note:

Do not attempt to move the trolley with an operator on board.

The Scaffold Attachment is now safe to use.

4. Removing The Scaffold

Removal of the scaffolding is simply a reversal of the installation procedure.

Removal of the scaffolding elements is subject to the requirements of the actual system used and is beyond the ROTAMAG scope of supply.

5. Removing the Scaffold Attachment

Once the scaffolding has been removed the rail hooks should be removed from the rail head and locked in the up position. The scaffold attachment should now be free from the rail and removed from the Connecta-Trolley.

Please Note: The scaffold attachment weighs approximately 19Kg and should be lifted by two operators.

Maintenance Instructions and Parts Breakdown

6. Preventive Maintenance

6.1 Daily / Pre Use Inspection

Before the Scaffold Attachment is used the following checks should be made:

Item	Check	Pass / Fail Criteria	Action
Frame Assembly	Distortion or obvious damage	Visual distortion greater than 5mm or fractured welds	Renew Complete Assembly
Rail Hooks	Damage or missing components	Components are Missing or do not work correctly	Renew Complete Hook Assembly
Scaffold location Leg and Swivel Plate	Damaged or seized components	Scaffold location Leg or swivel plate is seized	Strip and grease components. Replace if worn.

6.2 Annual Inspection and Maintenance

Before the Scaffold Attachment is used the following checks should be made:

Item	Check	Pass / Fail Criteria	Action
Frame Assembly	Damage to paint finish	Chipped paint or visible rust	Renew Complete Assembly
Swivel Plate and Location Leg	Damage to Leg and wear to plate	Damaged or worn parts	Renew Complete Assembly
Swivel Plate locking Screws	Damage or Missing locking screws	Damaged or lost parts	Replace Screw

7. Corrective Maintenance

Damage outside what is stated above should result the unit being replaced and not used any longer.

8. Parts Breakdown

8.1 Complete Scaffold Attachment

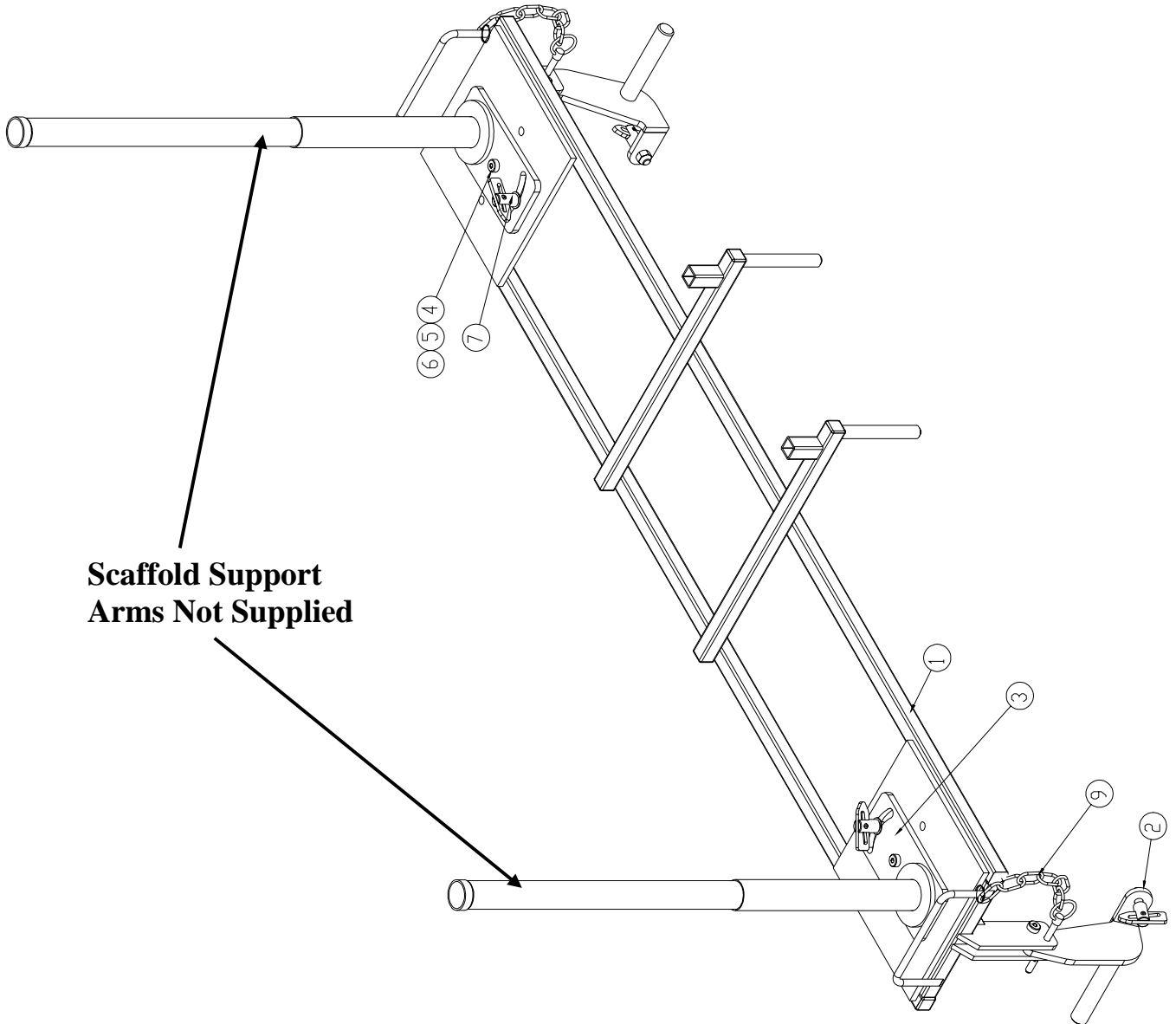

Scaffold Attachment Parts List

Note:

To order a complete scaffold attachment you should use the Part No:- **Lscaff-fbg**

All other parts should be ordered under the following Part No:-

ITEM NO.	QTY.	PART NO.	DESCRIPTION
1	1	Lscaff-frame	MAIN FRAME ASSEMBLY
2	2	Lscaff-astd	CLAMP ARM STANDARD
3	2	Lscaff-tpfbg	TOP PLATE ASSEMBLY
4	2	SC1020SB	M10x20 SHOULDER BOLT
5	4	NYLOC_NUT-M10	M10 NYLOC NUT
6	2	washer_12	M12 WASHER
7	2	Lscaff-20	M12x36 QUICK LOOSE FITTING
8	2	SC1030SB	M10x30 SHOULDER BOLT
9	2	Lscaff-33	JAEGER TOGGLE PIN (Ø3/8")

8.2 Rail Hooks (Clamp Arms)

To order a complete Rail Hook (Clamp Arm) you should use the following Part No:- **Lscaff-astd**

Any other parts which make up the complete Rail Hook (Clamp Arm) Should use the following Part No:-

ITEM NO.	QTY.	PART NO.	DESCRIPTION
1	1	Lscaff-17	Arm side plate
2	1	Lscaff-18	Arm handle
3	1	Lscaff-19	Arm front plate
4	1	Lscaff-20	M12x36 quick loose fitting
5	1	NUT-M12	M12 nut

The following diagram shows a breakdown of the Rail Hook (Clamp Arm).

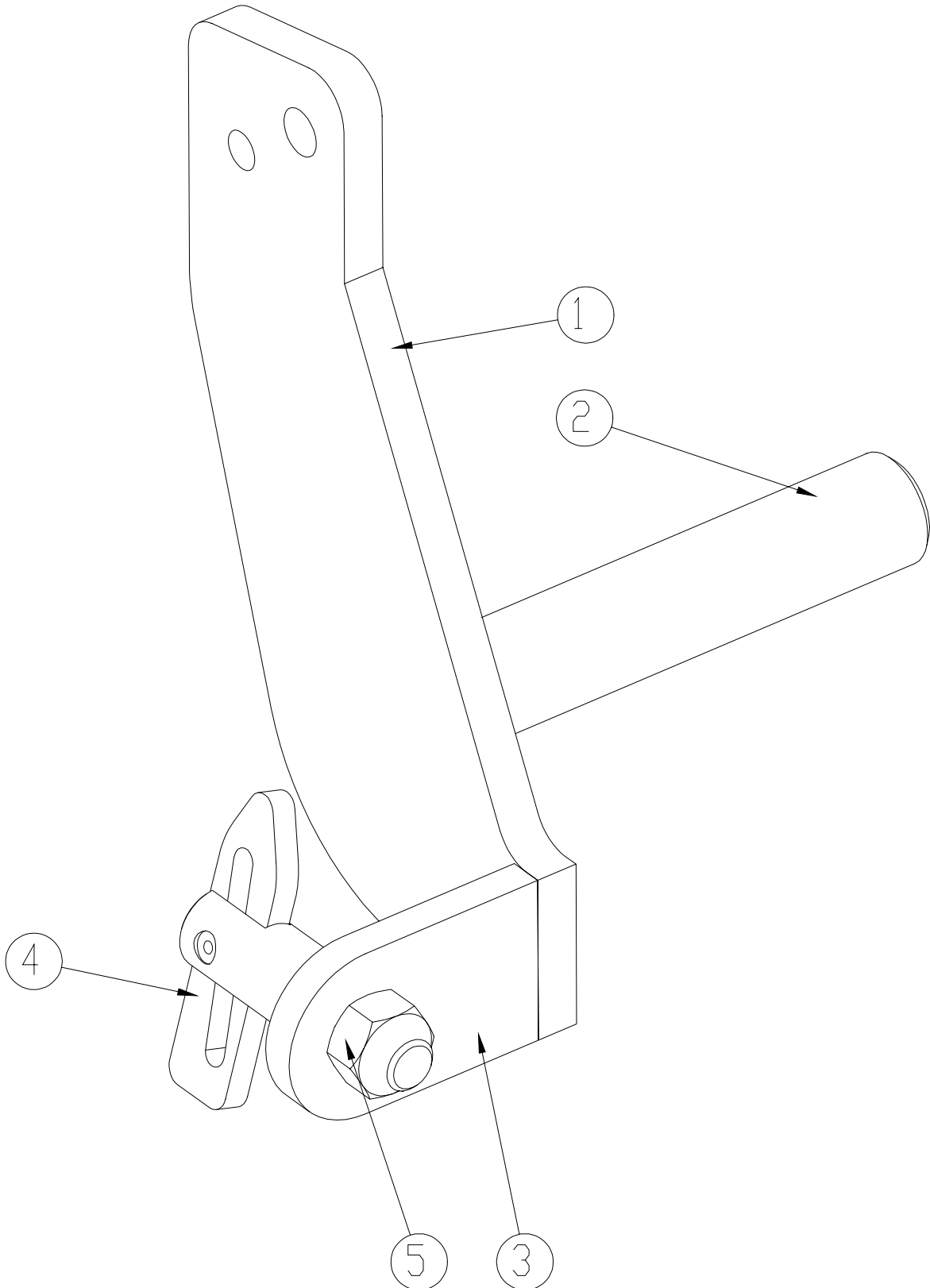

8.3 Swivel Bracket (Top Plate Assembly)

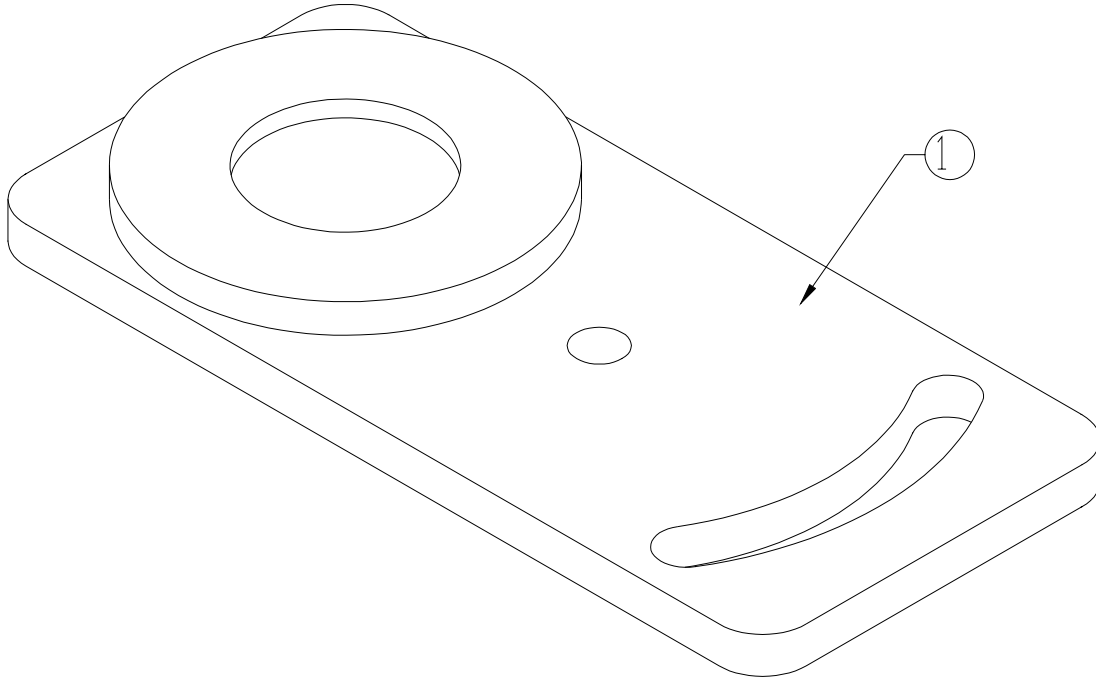

To order a complete Swivel Bracket (Top Plate Assembly) you should use the following part No:- **Lscaff-tpfbg**

Any other parts which make up the complete Swivel Bracket (Top Plate Assembly) Should use the following Part No:-

ITEM NO.	QTY.	PART NO.	DESCRIPTION
1	1	Lscaff-tpfbg	Pivot Plate Fabrication