

This sheet provides important operation and maintenance information to promote safe and consistent service.

IMPORTANT: When moving an XL Radiomaster carriage, always fold out and lock the handle into place first.

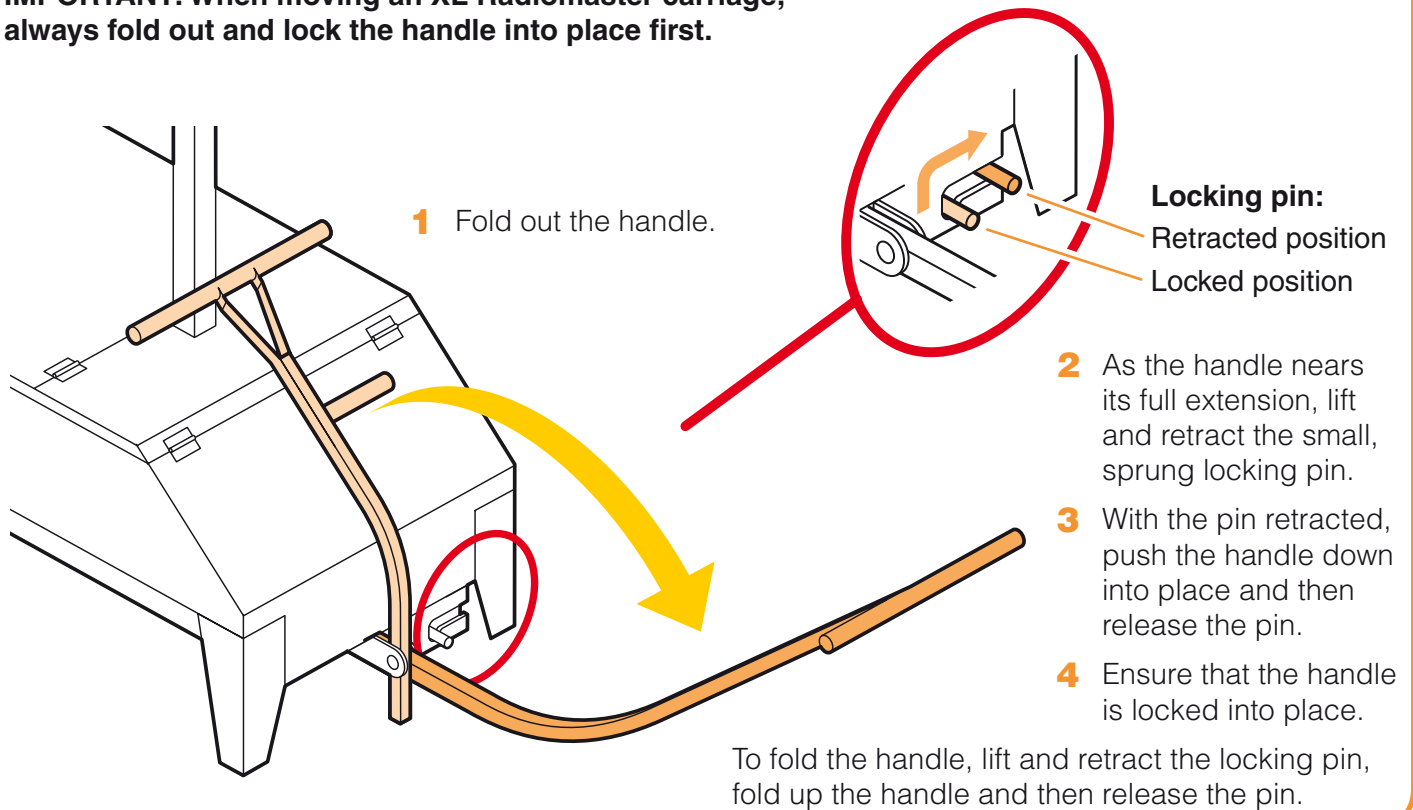

Loading and unloading

- Place the trailer on level ground and ensure that it cannot move.
- Before using the ramp, lower both prop stands and the jockey wheel to the ground and secure.
- Always use the winch when loading and unloading each XL Radiomaster carriage.

Ensure the jockey wheel is correctly adjusted and both prop stands are lowered to the ground

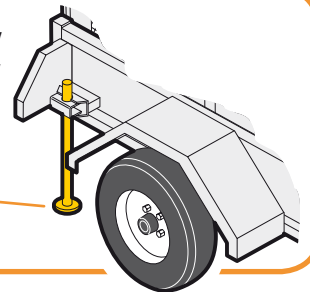

Routine maintenance

Prior to use, please make the following checks:

- On each carriage, check that the handle pivots are clean and that each handle moves with ease.
- On each carriage, check that the locking pin channel and its return spring are clean and that each locking pin moves with ease. If a locking pin does not return to its locked position then the spring may need to be replaced.
- On the trailer, in addition to the standard road-worthiness checks, ensure that the lynch pins (which hold each XL Radiomaster carriage in place) are clean and can be moved with ease.
- On each carriage, check that the wheels are in good condition and show no signs of cracking or excessive wear.

Remedies

- 1** If necessary, clean off any contaminants using a suitable method.
- 2** Apply a silicon-based lubricant spray to the movable part.

IMPORTANT: Do not use grease on any areas as this will attract further contamination.

Replace any carriage wheels that show signs of wear or damage.

IMPORTANT: If any damage is discovered, do not use the unit until the problem is fully remedied.